

KINGS MEADOW



# THE CYPRUS

HOMES 1, 2, 15, 16, 17, 310,  
311, 312, 341, 342, 343, 344,  
345, 348 & 349

Four bedroom home

The Cyprus offers flexible living over three storeys. The ground floor features a living / dining area opening onto the garden via French doors, with separate kitchen, plus a utility and cloakroom. The first floor features bedroom 1 with dressing room and en suite, bedroom 2 and a family bathroom. The second floor features two double bedrooms, one with an en suite.



ALLISON  
HOMES





### GROUND FLOOR

<b>Living / Dining</b>	4589mm x 4087mm	15'1" x 13'5"
<b>Kitchen</b>	3314mm x 3049mm	10'11" x 10'0"
<b>Utility</b>	2219mm x 2034mm	7'3" x 6'8"
<b>WC</b>	2034mm x 1008mm	6'8" x 3'4"

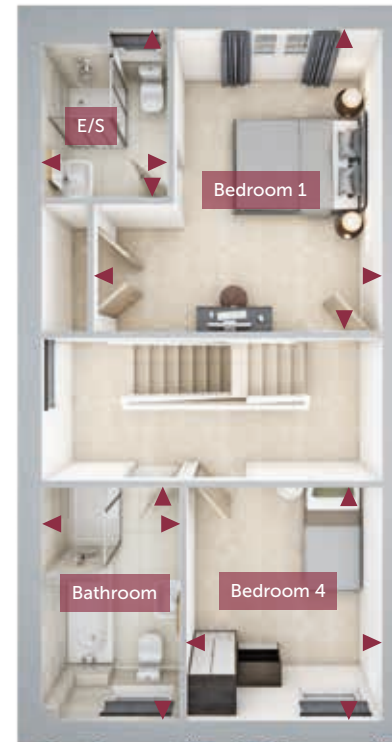

### FIRST FLOOR

<b>Bedroom 1</b>	4086mm x 3889mm	13'5" x 12'9"
<b>En suite</b>	2275mm x 1695mm	7'6" x 5'7"
<b>Bedroom 4</b>	3155mm x 2639mm	10'4" x 8'8"
<b>Bathroom</b>	3155mm x 1862mm	10'4" x 6'1"



### SECOND FLOOR

<b>Bedroom 2</b>	4588mm x 4103mm	15'1" x 13'6"
<b>Bedroom 3</b>	4588mm x 3074mm	15'1" x 10'1"

◀▶ - DIMENSION LOCATION

All images used are for illustrative purpose only. Dimensions given are illustrative for this house type and individual properties may differ. Please check with your Sales Executives in respect of individual properties. We give maximum dimensions within each room and these may include areas of fixtures and fittings including fitted furniture. These dimensions should not be used for carpet or flooring sizes, appliance spaces or items of furniture. All images, photographs and dimensions are not intended to be relied upon for, nor to form part of any contract unless specifically incorporated in writing into the contract.

