

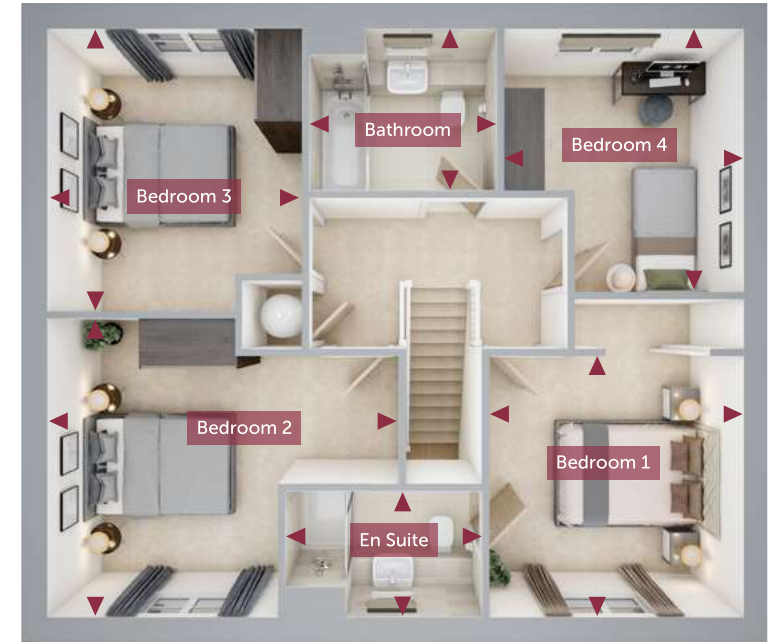

## GROUND FLOOR

<b>Living Room</b>	4500mm x 3140mm	14'9" x 10'4"
<b>Kitchen/Dining</b>	8730mm x 3080mm	28'8" x 10'10"
<b>Utility</b>	2150mm x 1850mm	7'0" x 6'1"
<b>Study</b>	3380mm x 1960mm	11'1" x 6'5"
<b>WC</b>	1850mm x 1070mm	6'1" x 3'6"



## FIRST FLOOR

<b>Bedroom 1</b>	3270mm x 3180mm	10'9" x 10'5"
<b>En Suite</b>	2470mm x 1580mm	8'1" x 5'2"
<b>Bedroom 2</b>	4400mm x 3740mm	14'6" x 12'4"
<b>Bedroom 3</b>	3540mm x 3190mm	11'8" x 10'6"
<b>Bedroom 4</b>	3300mm x 3000mm	10'10" x 9'10"
<b>Bathroom</b>	2355mm x 2020mm	7'9" x 6'8"

◀▶ - DIMENSION LOCATION

All images used are for illustrative purpose only. Dimensions given are illustrative for this house type and individual properties may differ. Please check with your Sales Executives in respect of individual properties. We give maximum dimensions within each room and these may include areas of fixtures and fittings including fitted furniture. These dimensions should not be used for carpet or flooring sizes, appliance spaces or items of furniture. All images, photographs and dimensions are not intended to be relied upon for, nor to form part of any contract unless specifically incorporated in writing into the contract.

