



THE LUCCOMBE

HOMES 10, 50, 51 & 57

Three bedroom home

The double-fronted design of the Luccombe translates into beautifully balanced living space, with lounge to one side of the hall and kitchen/diner to the other. Both rooms run front to rear so light flows effortlessly, and both open to the rear garden. Upstairs bedroom 1 with en suite, a second double and a single, plus family bathroom radiate from the landing.



Bedroom 1	3562mm x 3076mm	11'7" x 10'1"
En suite	2411mm x 1583mm	7'9" x 5'2"
Bedroom 2	3718mm x 3087mm	12'2" x 10'1"
Bedroom 3	2486mm x 2486mm	8'2" x 8'2"
Bathroom	1970mm x 1700mm	6'5" x 5'6"

FIRST FLOOR

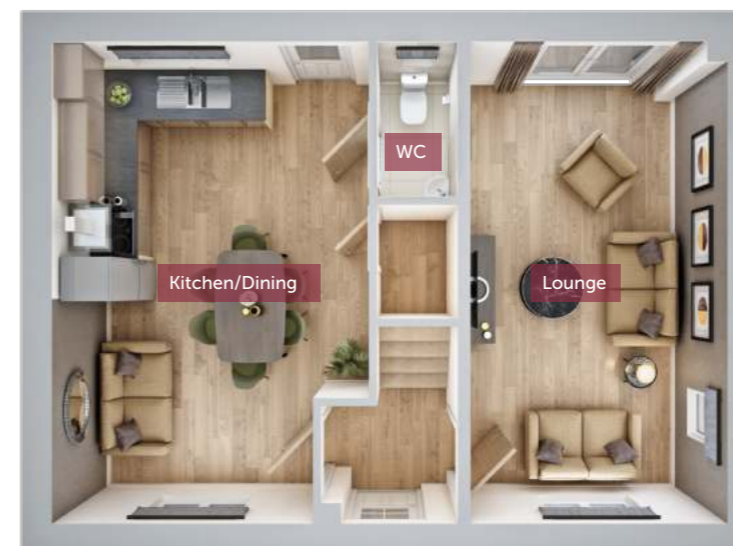

Lounge	5634mm x 3027mm	18'5" x 9'9"
Kitchen/Dining	5634mm x 3678mm	18'5" x 12'1"
WC	1080mm x 935mm	3'5" x 3'1"

GROUND FLOOR

All images used are for illustrative purpose only. Dimensions given are illustrative for this house type and individual properties may differ. Please check with your Sales Executives in respect of individual properties. We give maximum dimensions within each room and these may include areas of fixtures and fittings including fitted furniture. These dimensions should not be used for carpet or flooring sizes, appliance spaces or items of furniture. All images, photographs and dimensions are not intended to be relied upon for, nor to form part of any contract unless specifically incorporated in writing into the contract.