



THE CRAB APPLE

HOMES 52, 53, 55, 56 & 57

Three bedroom home

The Crab Apple offers a comfortable lounge/dining space, opening up to the garden via French doors, and a separate kitchen. There is also a cloakroom to the ground floor. Upstairs are two double bedrooms, with bedroom 1 benefiting from an en suite, and a single bedroom. There is a family bathroom.

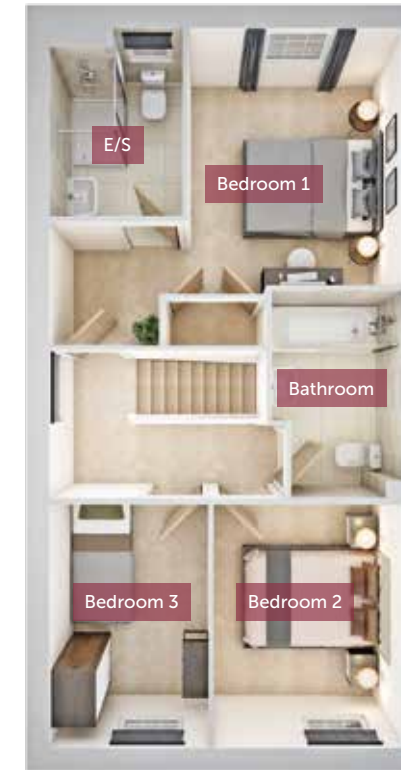

Bedroom 1	4580mm x 2790mm	15'0" x 9'1"
En suite	2440mm x 1710mm	8'0" x 5'6"
Bedroom 2	3150mm x 2450mm	10'3" x 8'0"
Bedroom 3	3150mm x 2050mm	10'3" x 6'7"
Bathroom	2700mm x 1700mm	8'9" x 5'6"

FIRST FLOOR

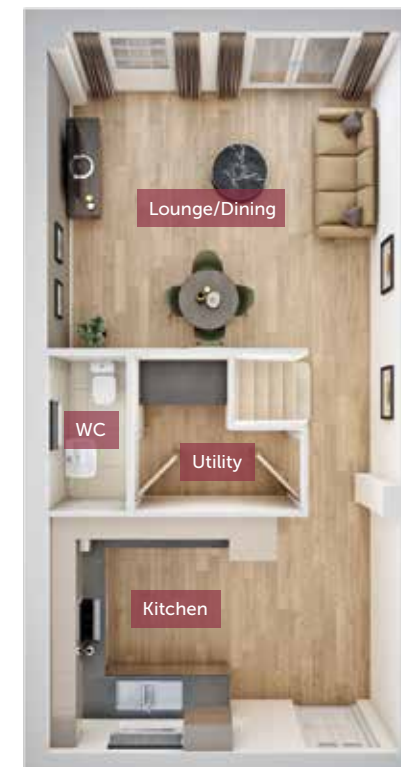

Lounge/Dining	4580mm x 4100mm	15'0" x 13'4"
Kitchen	4580mm x 3050mm	15'0" x 10'0"
Utility	2210mm x 2030mm	7'2" x 6'7"
WC	2034mm x 1007mm	6'7" x 3'3"

GROUND FLOOR

All images used are for illustrative purpose only. Dimensions given are illustrative for this house type and individual properties may differ. Please check with your Sales Executives in respect of individual properties. We give maximum dimensions within each room and these may include areas of fixtures and fittings including fitted furniture. These dimensions should not be used for carpet or flooring sizes, appliance spaces or items of furniture. All images, photographs and dimensions are not intended to be relied upon for, nor to form part of any contract unless specifically incorporated in writing into the contract.