



# THE HOLLY

HOMES 6, 8, 26, 27, 43, 52, 53, 66, 78, 79,  
96, 119, 138, 146, 153, 155, 166 219, 223,  
246, 269, 287 & 327

Three bedroom home

The detached Holly offers carefully balanced living space with both the living room and kitchen / dining room benefiting from a dual-aspect design. The ground floor also features a cloakroom. Upstairs is bedroom 1 with en suite, a further double and a single bedroom, as well as a family bathroom.



FIRST FLOOR

<b>Bedroom 1</b>	3850mm x 3150mm	12'6" x 10'3"
<b>En suite</b>	2000mm x 1670mm	6'6" x 5'5"
<b>Bedroom 2</b>	2620mm x 2610mm	8'7" x 8'6"
<b>Bedroom 3</b>	2730mm x 2100mm	9'0" x 6'9"
<b>Bathroom</b>	2760mm x 1780mm	9'0" x 5'8"

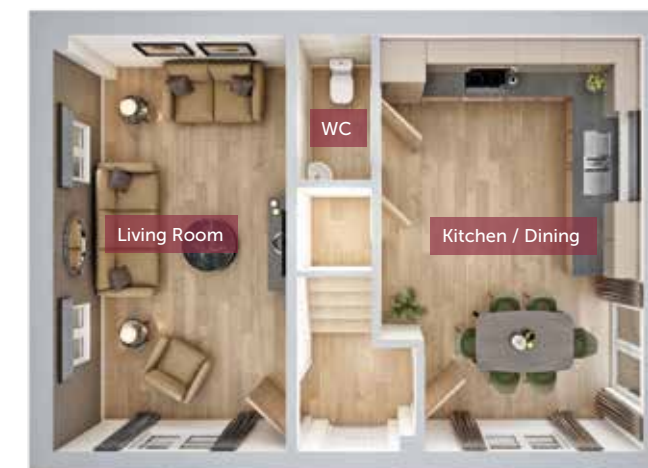

GROUND FLOOR

<b>Living Room</b>	5640mm x 3700mm	18'5" x 12'1"
<b>Kitchen / Dining</b>	5649mm x 3580mm	18'5" x 11'7"
<b>WC</b>	1960mm x 1010mm	6'4" x 3'3"

All images used are for illustrative purpose only. Dimensions given are illustrative for this house type and individual properties may differ. Please check with your Sales Executives in respect of individual properties. We give maximum dimensions within each room and these may include areas of fixtures and fittings including fitted furniture. These dimensions should not be used for carpet or flooring sizes, appliance spaces or items of furniture. All images, photographs and dimensions are not intended to be relied upon for, nor to form part of any contract unless specifically incorporated in writing into the contract.