

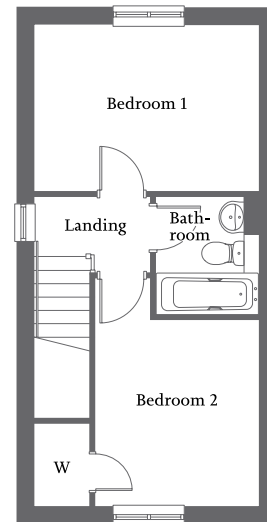

Front aspect living room | Kitchen/dining area with French Doors |  
Fitted wardrobe to bedroom two | One further bedroom and family bathroom | Allocated parking spaces |

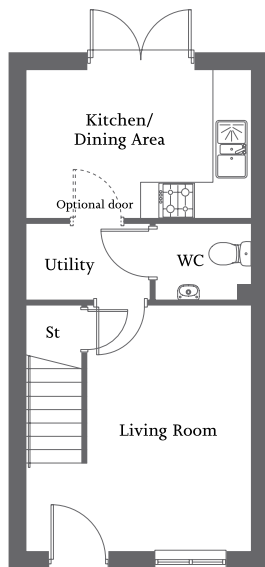

**Ground Floor**

Living Room	4.09m x 3.72m	13'6" x 12'2"
Kitchen/Dining Area	3.72m x 2.47m	12'2" x 8'1"
Utility	2.06m x 1.27m	6'9" x 4'2"

**First Floor**

Bedroom 1	3.72m x 2.77m	12'2" x 9'1"
Bedroom 2	3.09m x 2.71m	10'1" x 8'10"
Bathroom	1.97m x 1.70m	6'5" x 5'7"