

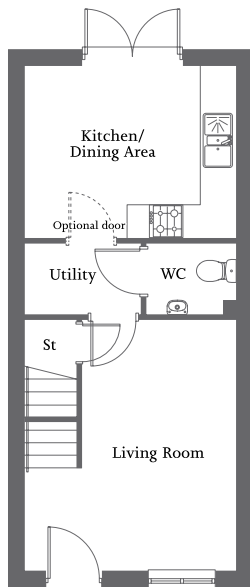

| Front aspect living room | Kitchen/dining area with French Doors |
| Fitted wardrobe to bedroom two | One further bedroom and family bathroom | Allocated parking space(s) |



Ground Floor

Living Room	4.46m x 3.71m	14'7" x 12'2"
Kitchen/Dining Area	3.05m x 3.71m	10'0" x 12'2"
Utility	1.14m x 1.27m	3'8" x 4'2"

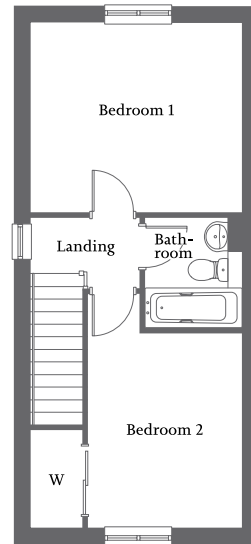

First Floor

Bedroom 1	3.35m x 3.71m	10'11" x 12'2"
Bedroom 2	3.46m x 2.71m	11'4" x 8'10"
Bathroom	1.97m x 1.70m	6'5" x 5'6"