

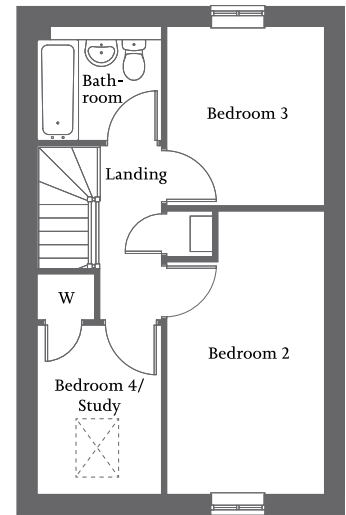

| Front aspect living room with Juliet balcony | Open-plan kitchen/dining/utility | Bedroom 1 and shower room to first floor |  
| Three further bedrooms and family bathroom to second floor | Single garage and allocated parking space |

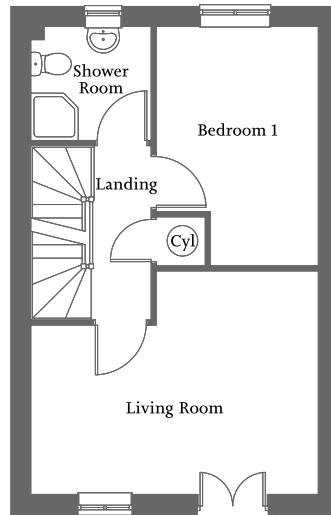
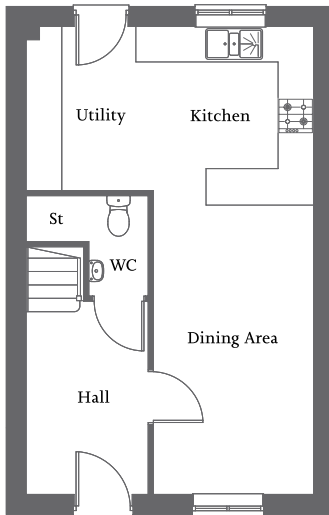

**Ground Floor**

Kitchen/Utility	4.86m x 2.75m	15'11" x 9'0"
Dining Area	4.95m x 2.70m	16'2" x 6'9"

**First Floor**

Living Room	4.86m x 3.75m	15'11" x 12'3"
Bedroom 1	4.03m x 2.68m	13'3" x 8'10"
Shower Room	2.02m x 1.91m	6'7" x 6'3"

**Second Floor**

Bedroom 2	4.76m x 2.66m	15'7" x 8'8"
Bedroom 3	3.01m x 2.66m	9'10" x 8'8"
Bedroom 4/ Study	2.84m x 2.08m	9'3" x 6'9"
Bathroom	2.08m x 1.91m	6'9" x 6'3"



Please note: Computer generated images and floorplans show a typical house type. Details may vary from plot to plot. All measurements shown are approximate maximum room dimensions and are + or - 50mm. They are not intended to be used for carpet sizes, appliance sizes or items of furniture. Floorplans depict a typical layout of this type. Please refer to the development brochure for confirmation of the plot numbers for this particular house type. Depending on plot number, the floor plans for this house type may be opposite to those shown above. Windows and other elevational treatments are subject to change and may differ at each development, please confirm details with your Sales Executive. For further information on the specific materials for your chosen property, exact plot specification, details of external and internal finishes, dimensions, floorplans and full site-specific details, please speak with your Sales Executive. Landscaping shown is for illustration purposes only. Levels and building heights are subject to change. Every care has been taken to ensure the accuracy of these particulars, but the contents shall not form part of any contract and the vendors reserve the right to alter the specification and/or design without notice.