



THE HEREFORD



2 bedrooms



1 bathroom/
en-suite



2 parking spaces

Front aspect living room

Kitchen/dining area with French doors

Utility area

Master bedroom and one further bedroom

Allocated parking for two cars

Built with you in mind



ALLISON
HOMES

THE HEREFORD



2 bedrooms



1 bathroom/
en-suite



2 parking spaces

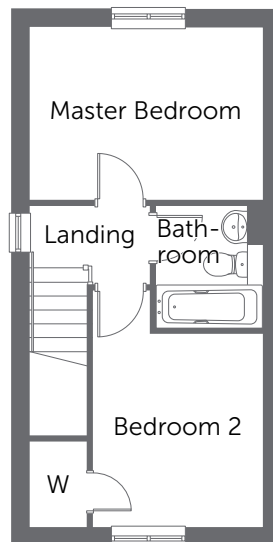
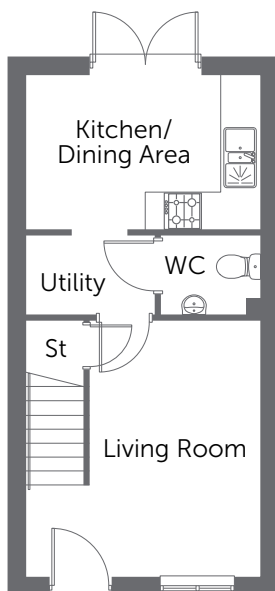

Ground Floor

Living Room	4.12m x 3.71m	13'6" x 12'2"
Kitchen/ Dining Area	3.71m x 2.45m	12'2" x 8'0"
Utility	2.06m x 1.25m	6'9" x 4'1"

First Floor

Master Bedroom	3.71m x 2.75m	12'2" x 9'0"
En-suite	3.07m x 2.70m	10'1" x 8'10"
Bedroom 2	1.95m x 1.67m	6'5" x 5'6"

CONSUMER
CODE FOR
HOME BUILDERS

www.consumercode.co.uk



Please note: All measurements shown are approximate maximum room dimensions and are + or - 50mm. They are not intended to be used for carpet sizes, appliance sizes or items of furniture. Floorplans depict a typical layout of this type. Please refer to the development brochure for confirmation of the plot numbers for this particular house type. Depending on plot number, the floor plans for this house type may be opposite to those shown above. Windows and other elevational treatments are subject to change and may differ at each development, please confirm details with your Sales Executive. For further information on the specific materials for your chosen property, exact plot specification, details of external and internal finishes, dimensions, floorplans and full site-specific details, please speak with your Sales Executive. Landscaping shown is for illustration purposes only. Levels and building heights are subject to change. Every care has been taken to ensure the accuracy of these particulars, but the contents shall not form part of any contract and the vendors reserve the right to alter the specification and/or design without notice.

2224 (652 sq ft) AP0921

Built with you in mind



ALLISON
HOMES