

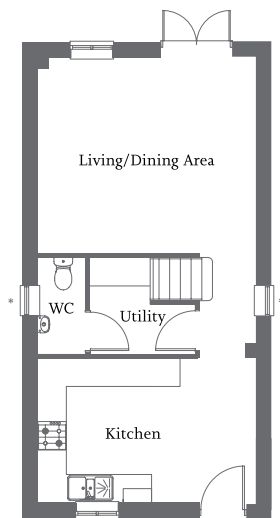

| Living/dining area with French Doors to rear | Front aspect kitchen |  
| Bedroom 1 with en suite and fitted wardrobe | Two further bedrooms and family bathroom | Allocated parking spaces |

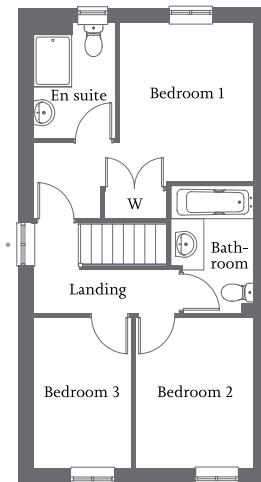

\* Windows to specific homes only



### Ground Floor

Living/Dining Area	4.61m x 4.11m	15'1" x 13'6"
Kitchen	4.61m x 3.10m	15'1" x 10'2"

### First Floor

Bedroom 1 (excl. wardrobe & door rebate)	3.32m x 2.77m	10'11" x 9'1"
En suite	2.33m x 1.43m	7'8" x 4'8"
Bedroom 2	3.16m x 2.43m	10'4" x 8'0"
Bedroom 3	3.16m x 2.03m	10'4" x 6'8"
Bathroom	2.70m x 1.70m	8'9" x 5'5"