



ALLISON
HOMES



Front aspect living area

Kitchen/dining area
with French Doors

Master bedroom with en-suite
and fitted wardrobe

Allocated parking spaces

Built with you in mind

THE WINTHORPE

3 bedroom home



ALLISON
HOMES

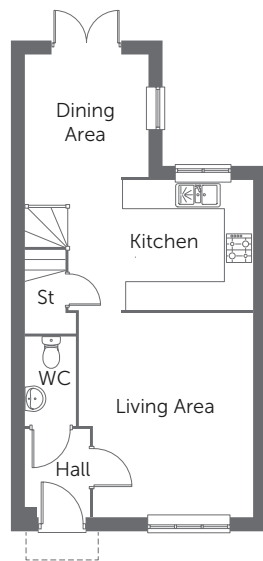

GROUND FLOOR

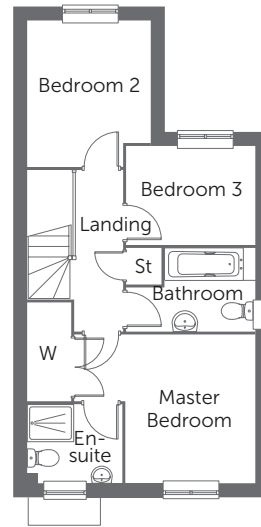

FIRST FLOOR

Ground Floor

Living Area	4.37m x 3.72m	14'4" x 12'2"
Kitchen	3.95m x 2.77m	12'2" x 9'1"
Dining Area	2.62m x 2.61m	8'7" x 8'6"

First Floor

Master Bedroom	3.17m x 2.77m	10'5" x 9'1"
En-suite	2.01m x 1.67m	6'7" x 5'6"
Bedroom 2	3.12m x 2.62m	10'2" x 8'7"
Bedroom 3	2.75m x 2.10m	9'0" x 6'10"
Bathroom	2.75m x 1.77m	9'0" x 5'10"

CONSUMER
CODE FOR
HOME BUILDERS

www.consumercode.co.uk



Please note: All measurements shown are approximate maximum room dimensions and are + or - 50mm. They are not intended to be used for carpet sizes, appliance sizes or items of furniture. Floorplans depict a typical layout of this type. Please refer to the development brochure for confirmation of the plot numbers for this particular house type. Depending on plot number, the floor plans for this house type may be opposite to those shown above. Windows and other elevational treatments are subject to change and may differ at each development, please confirm details with your Sales Advisor. For further information on the specific materials for your chosen property, exact plot specification, details of external and internal finishes, dimensions, floorplans and full site-specific details, please speak with your Sales Advisor. Landscaping shown is for illustration purposes only. Every care has been taken to ensure the accuracy of these particulars, but the contents shall not form part of any contract and the vendors reserve the right to alter the specification and/or design without notice.

2308 (918 sq ft)

Built with you in mind

THE WINTHORPE

3 bedroom home