



ALLISON  
HOMES



Living/dining area  
with French Doors

Front aspect kitchen

Separate utility

Master bedroom with en-suite  
and fitted wardrobe

Allocated parking spaces

Built with you in mind

THE BENINGTON

3 bedroom home



ALLISON  
HOMES

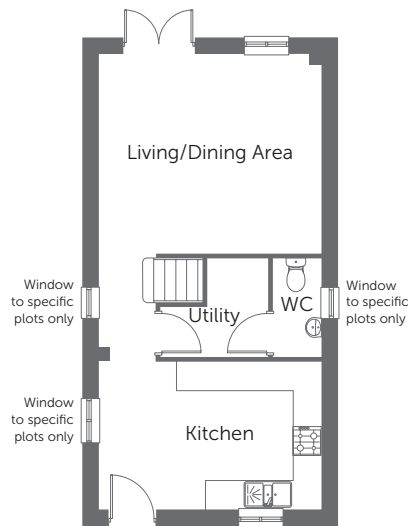

GROUND FLOOR

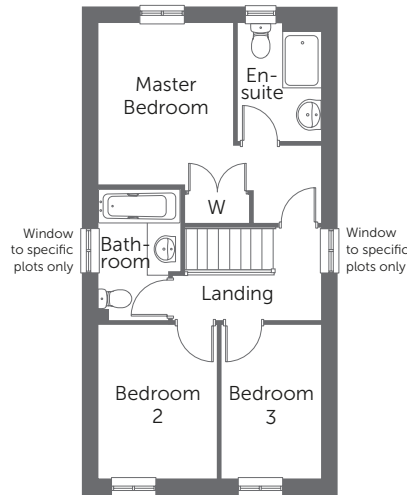

FIRST FLOOR

### Ground Floor

Living/ Dining Area	4.59m x 4.12m	15'0" x 13'6"
Kitchen	4.59m x 3.05m	15'0" x 10'0"
Utility	2.21m x 2.03m	7'3" x 6'8"

### First Floor

Master Bedroom	3.33m x 2.79m	10'11" x 9'1"
En-suite	2.44m x 1.71m	8'0" x 5'7"
Bedroom 2	3.17m x 2.45m	10'4" x 8'0"
Bedroom 3	3.17m x 2.05m	10'4" x 6'8"
Bathroom	2.70m x 1.70m	8'10" x 5'6"

CONSUMER  
CODE FOR  
HOME BUILDERS

www.consumercode.co.uk



Please note: All measurements shown are approximate maximum room dimensions and are + or - 50mm. They are not intended to be used for carpet sizes, appliance sizes or items of furniture. Floorplans depict a typical layout of this type. Please refer to the development brochure for confirmation of the plot numbers for this particular house type. Depending on plot number, the floor plans for this house type may be opposite to those shown above. Windows and other elevational treatments are subject to change and may differ at each development, please confirm details with your Sales Advisor. For further information on the specific materials for your chosen property, exact plot specification, details of external and internal finishes, dimensions, floorplans and full site-specific details, please speak with your Sales Advisor. Landscaping shown is for illustration purposes only. Every care has been taken to ensure the accuracy of these particulars, but the contents shall not form part of any contract and the vendors reserve the right to alter the specification and/or design without notice.

2329 (934 sq ft)

# THE BENINGTON

Built with you in mind

3 bedroom home