

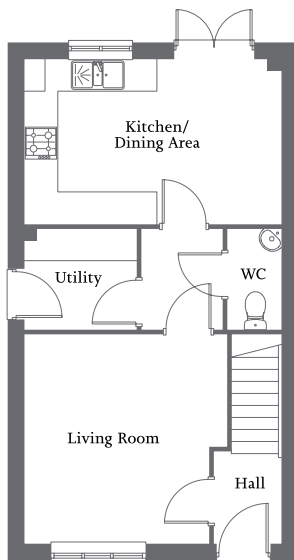

Front aspect living room | Kitchen/dining area with French Doors |
En suite and fitted wardrobe to bedroom 1 | Two further bedrooms and family bathroom | Allocated parking spaces



Ground Floor

Living Room	3.90m x 3.76m	12'9" x 12'4"
Kitchen/Dining Area	4.76m x 3.76m	15'7" x 12'4"
Utility	2.06m x 1.87m	6'9" x 6'1"

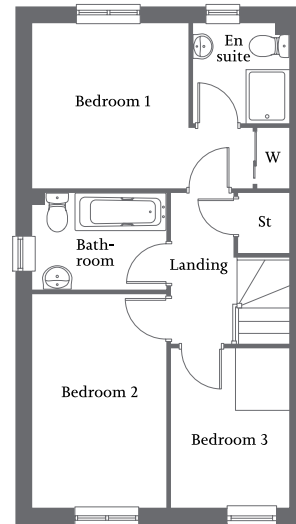

First Floor

Bedroom 1	4.09m x 3.07m	13'5" x 10'1"
En suite	1.86m x 1.77m	6'1" x 5'9"
Bedroom 2	3.97m x 2.48m	13'0" x 8'1"
Bedroom 3	2.96m x 2.19m	9'8" x 7'2"
Bathroom	2.48m x 1.80m	8'1" x 5'10"